

HYBRID ROOF CURBS

Installation Guide

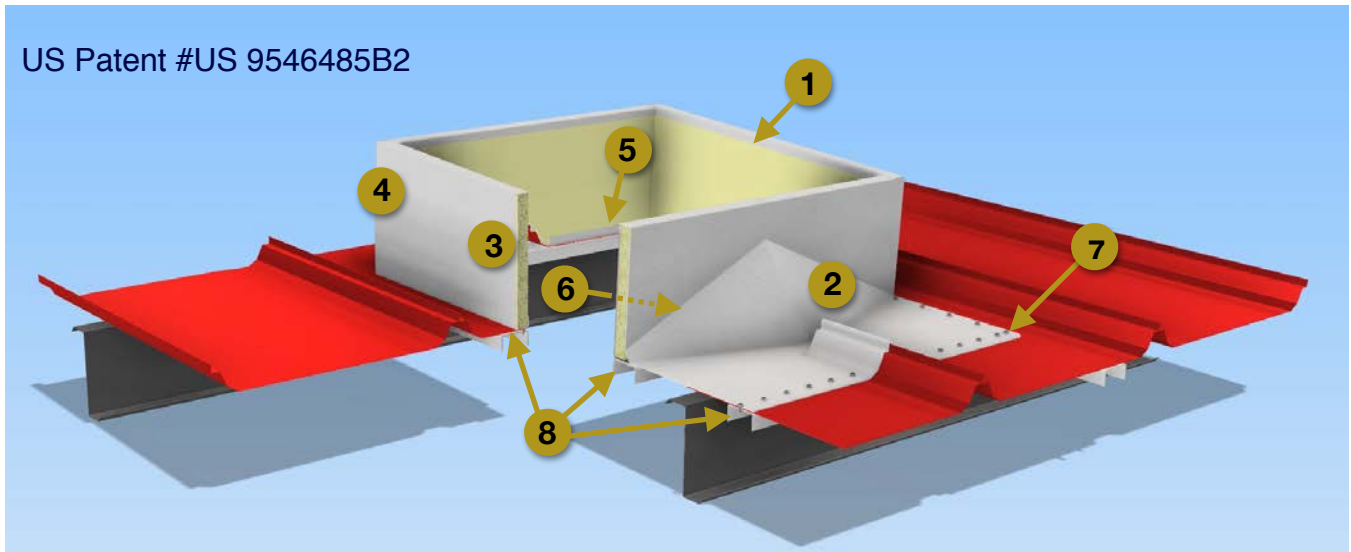

US Patent #US 9546485B2



Our patented, one piece, hybrid roof curb is engineered to be a step toward the next generation of design.

Patented and proven performance.

By selecting this hybrid roof curb, you have selected a proven product that is easy to install.

Decades of experience have led us to this point. With thousands of roof curbs under our belt, it is no wonder we are able to continue to innovate and improve our hybrid roof curbs.

There are dozens of roof curbs on the market today, what sets **SSM** apart is the attention to detail and the continuous evolution of our patented design.

Architectural / Commercial / Design / Engineering / Fabrication / Industrial / Installation

SSM / 405 NORTH OLIVE STREET / KANSAS CITY, MO 64120 / 816.221.5434



Engineered for ease of Installation.

SSM's one piece hybrid curb solution is designed to make installation easy.

A] Set the curb in place and mark the area to be removed.



B] Cut the opening needed and trim back the roof's standing seam components as needed for the curb to seat properly.

C] Clean the area around the opening to remove loose particles.



D] Apply double stick butyl tape [provided] to the underneath side of the perimeter of the roof curb.

E] Trim all excess butyl and check to see that the tape is secure.

F] Remove the backing layer from the tape and flip the hybrid roof curb over - holding it above the roof opening - and check for proper alignment.



G] Place curb in position and press down along the butyl tape edges to ensure even contact.

H] Secure the curb in place, as per the provided fastener holes, with mechanical fasteners [provided].

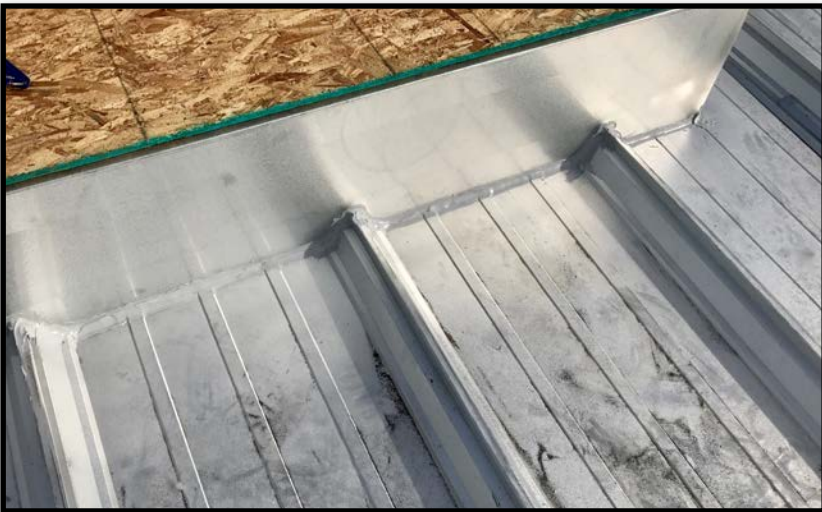

I] Clean up the area around the opening joint between hybrid curb and roof to remove any loose particles.

J] Apply caulk around the perimeter of the hybrid curb in an even and concise manner, utilizing the proper tools, to ensure a consistent seal.



That is it! You are ready to move on to the next one!

Parts:

1. 24 gauge Galvalume®, welded cap is part of our patented design.
2. Integral water diverter cricket.
3. Except as noted, our components are 18 ga. Galvalume®. Our standard Top Flange is 1 1/2" wide but this can vary depending upon your job requirements.
4. Standard height is 10" and sloped to the roof pitch to provide a level mounting surface, based upon your project's specific needs.
5. The bottom flange, found on 3 sides, is also 1 1/2" wide but custom widths are available.
6. The interior of the Cricket is full enclosed and insulated.
7. Pre-laid out fastener holes, 9/32" in diameter, are placed at 3" [max.] centers around the full curb perimeter.
8. Purlins, enhance stability of the roof, improving both safety and performance.

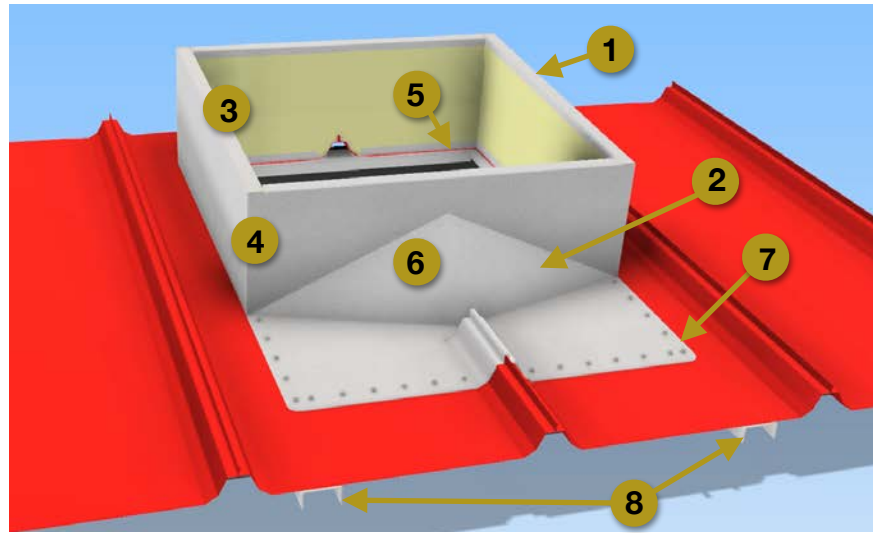

Company Profile:

SSM was founded in 1983 as Standard Sheet Metal, Inc. Over the last 35 years Standard Sheet Metal has become an industry leader in the architectural, commercial and custom sheet metal markets.

Today our capabilities far surpass those initially recognized during the early years. We have recently rebranded the company to "**SSM**". While sheet metal has been the core of our initial business, we have broadened our capabilities beyond just sheet metal.

From metal building facades, sculptures, hybrid roof curbs, artwork to themed environment fabrication, **SSM** can be your single source for design, fabrication and installation on your project.

